

AO

RUBINETTI PER ACQUA

WATER TAPS

ROBINETS POUR EAU

GRIFOS PARA AGUA

Distribuito da :



DAL 1945 PARTNER PER IL
LABORATORIO CHIMICO

www.labotech2000.it e-mail: info@labotech2000.it
PEC: infolabotech2000@pec.it

LABOTECH2000 SRL

Uff. comm. 20090 Cusago (MI)

V.le Europa 72 D/11

Tel.0290394213 Fax.0290393715

Seda Legale: 20100 Milano

C.so P.ta Vittoria 14

Part. IVA 13308530156

R.E.A. n. 1636581

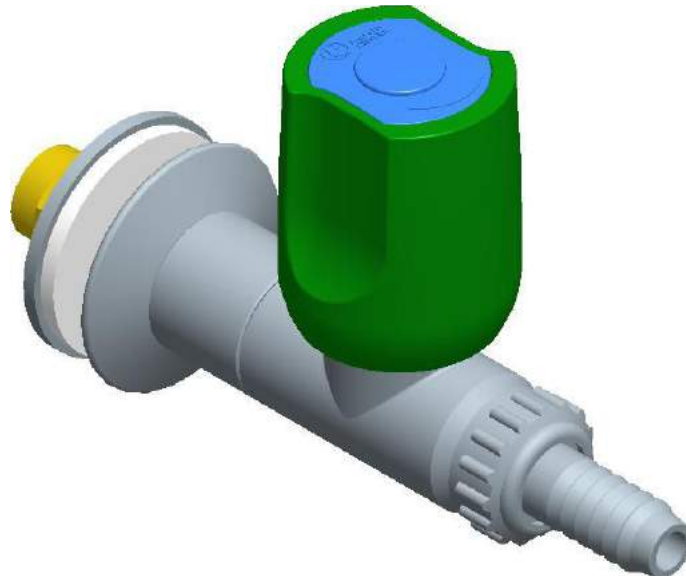

AO1000

Rubinetto diretto con portagomma svitabile
Straight tap with removable nozzle



AO1001

Rubinetto a 90° con portagomma svitabile
90° tap with removable nozzle



AO1002

Rubinetto 90° con maniglia inclinata e portagomma svitabile
90° tap with inclined handle and removable nozzle



AO1003

Rubinetto a 45° con portagomma svitabile
45° tap with removable nozzle

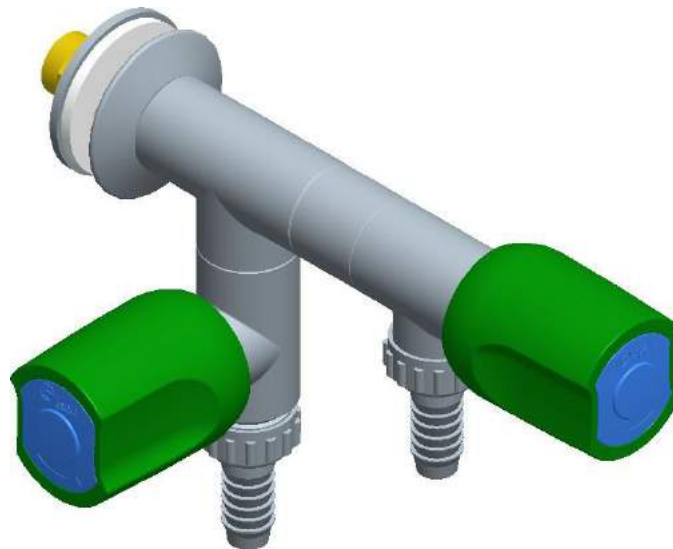

A01010

Rubinetto pompa vuoto destro e sinistro
Left and right taps for vacuum pump



A01020

Rubinetto 90° a parete
90° wall-mounted tap

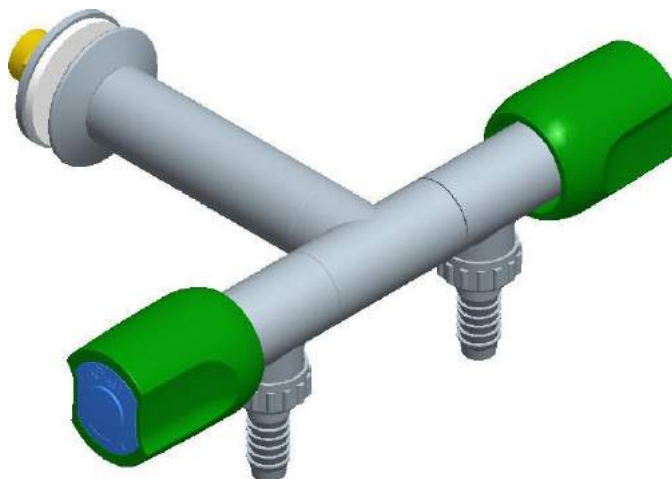

AO1021

Rubinetto 90° a parete a T
90° wall-mounted T tap

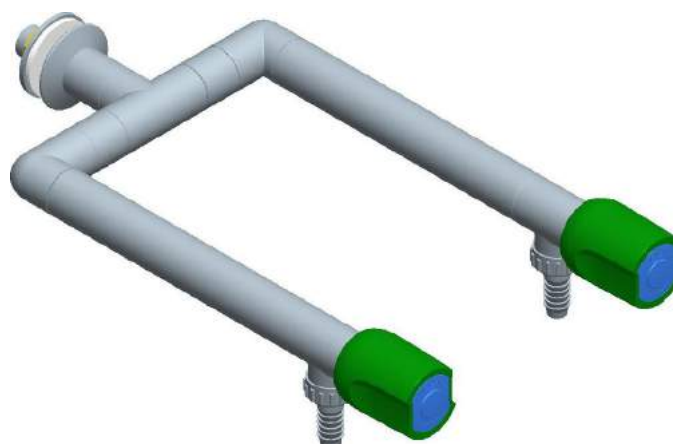

AO1023

Rubinetto 90° a parete a U
90° wall-mounted U tap

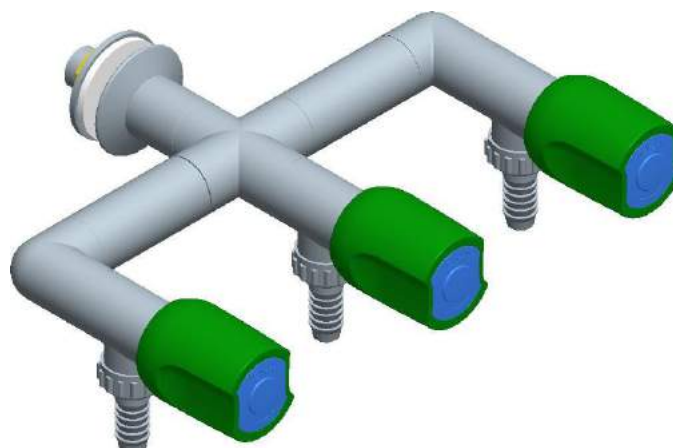

AO1024

Rubinetto 90° a parete a tre vie
90° 3-way wall-mounted tap

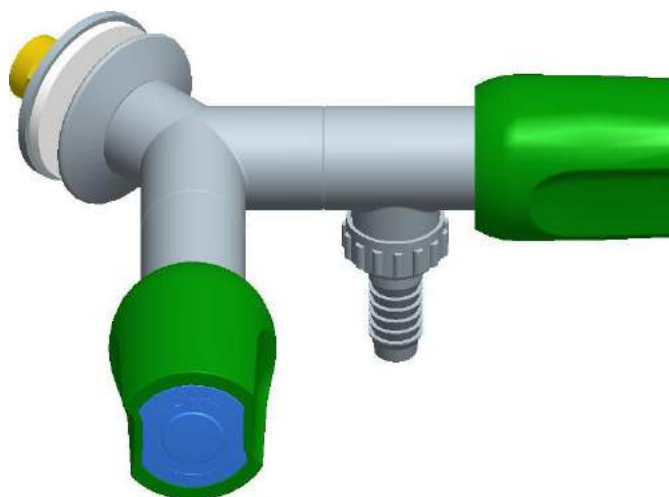

AO1025

Rubinetto 90° a parete a V
90° wall-mounted V tap

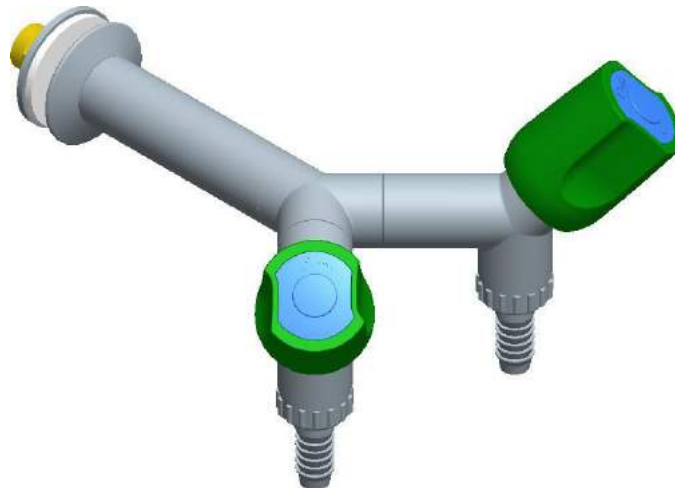

A01026

Rubinetto 90° a parete con maniglie inclinate
90° wall-mounted tap with inclined handles

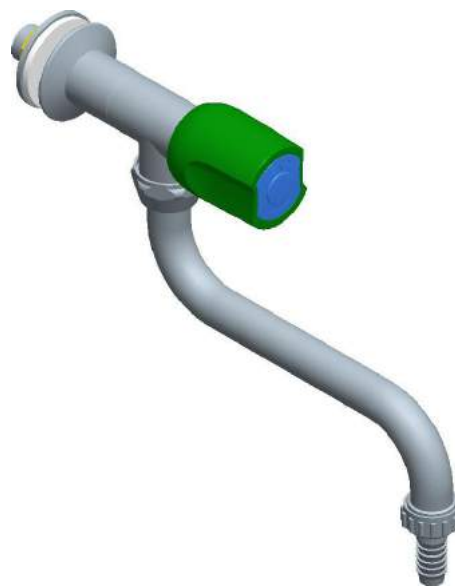

A01030

Rubinetto a parete con canna a S girevole
Wall-mounted tap with S swivelling spout

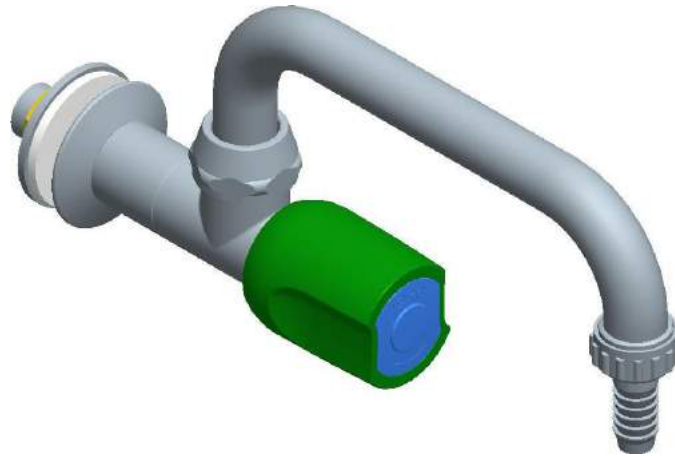

A01031

Rubinetto a parete con canna a U girevole
Wall-mounted tap with U swivelling spout



A01032

Canna collo cigno girevole a parete
Wall-mounted gooseneck swivelling spout



A01033

Rubinetto a parete con canna collo cigno girevole
Wall-mounted tap with gooseneck swivelling spout

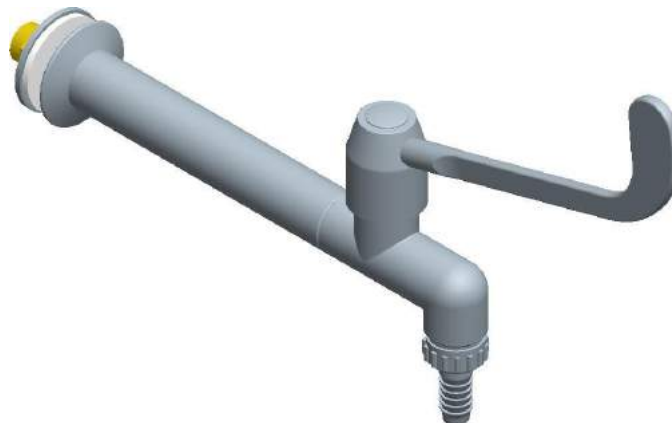

A01034

Rubinetto a parete con leva clinica e vitone ceramico
Wall-mounted tap with lever and ceramic head valve



A01035

Miscelatore monoforo a parete
Wall-mounted single hole mixer

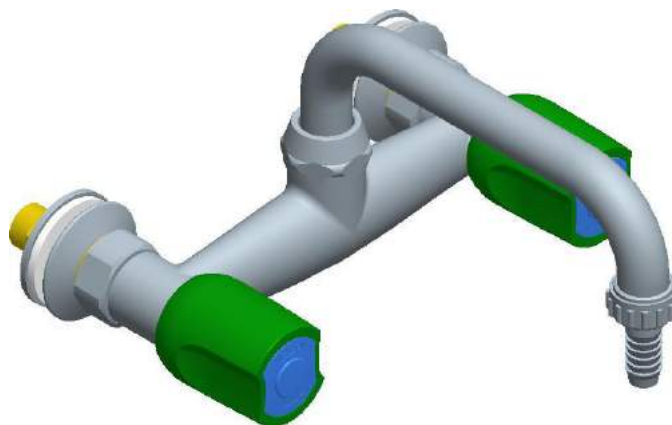

A01036

Miscelatore lavello a parete con canna a U girevole
Wall-mounted mixer with U swivelling spout



A01037

Miscelatore a parete con canna a S girevole
Wall-mounted mixer with S swivelling spout

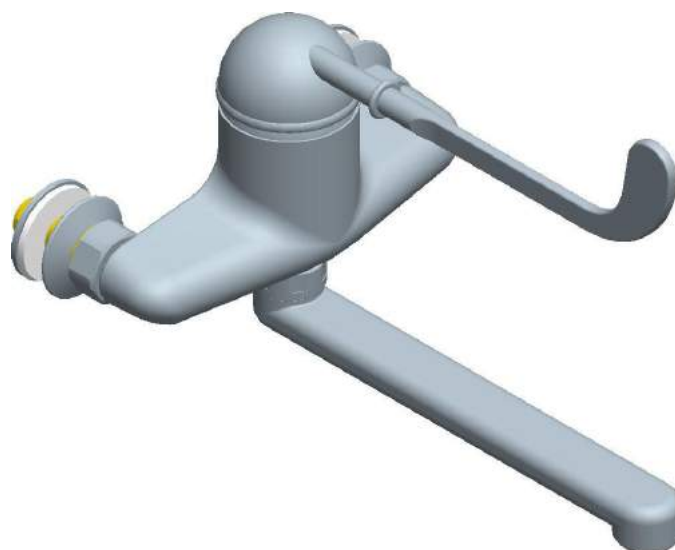

A01038

Miscelatore a parete a leva clinica con areatore
Wall-mounted mixer with long lever and aerator

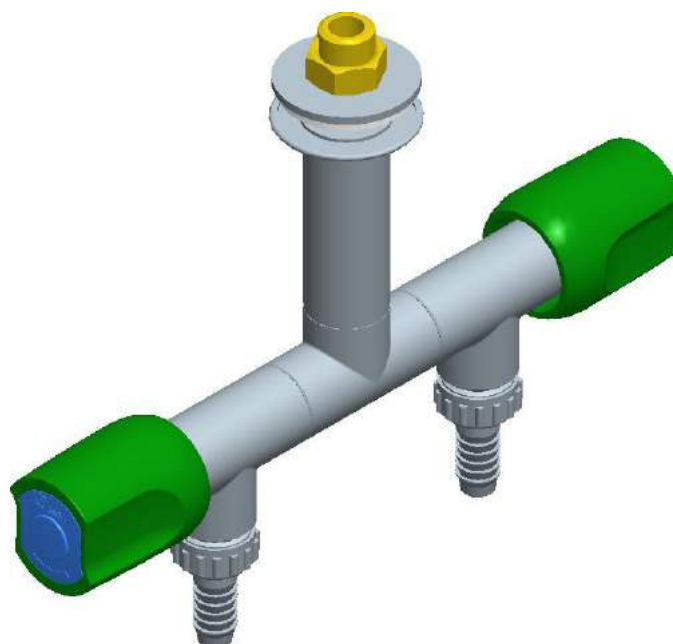

AO1040

Rubinetto a T verticale con maniglie laterali
Vertical T tap with side handles

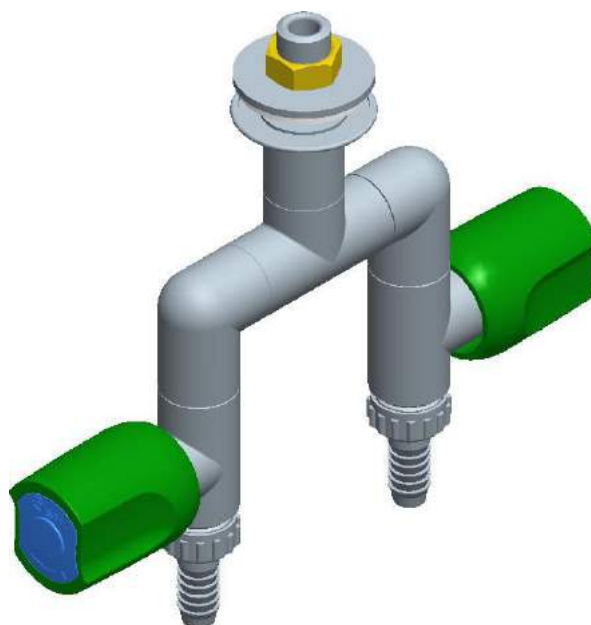

AO1041

Rubinetto a U verticale con maniglie laterali
Vertical U tap with side handles

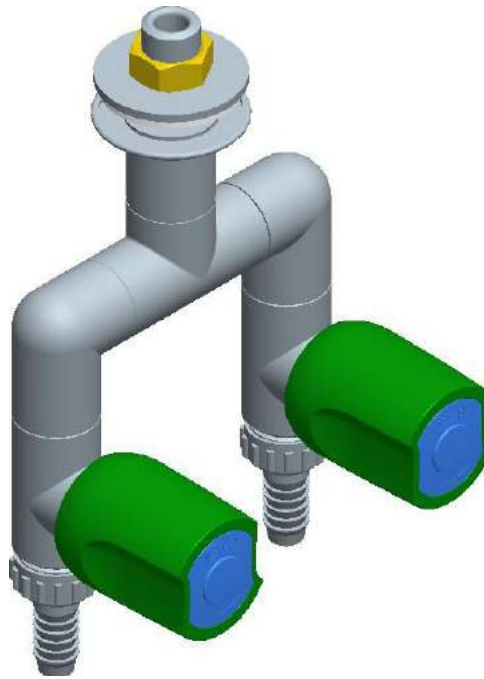

A01042

Rubinetto a U verticale con maniglie frontali
Vertical U tap with frontal handles

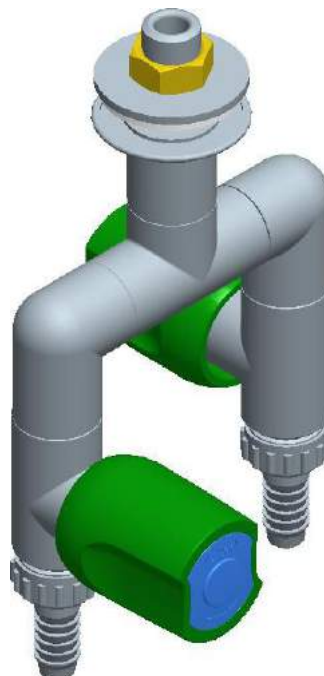

A01043

Rubinetto a U verticale con maniglie opposte
Vertical U tap with opposite handles

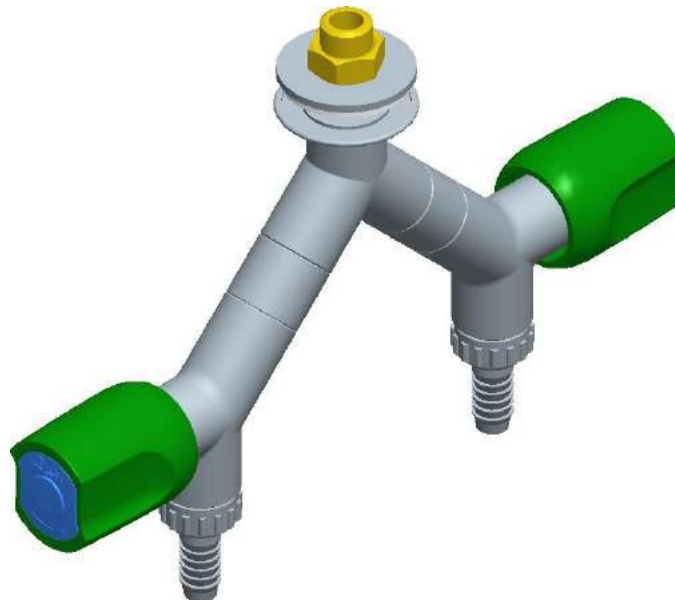

A01044

Rubinetto a V verticale con maniglie laterali
Vertical V tap with side handles



A01045

Comando con flessibili
Remote control with flex

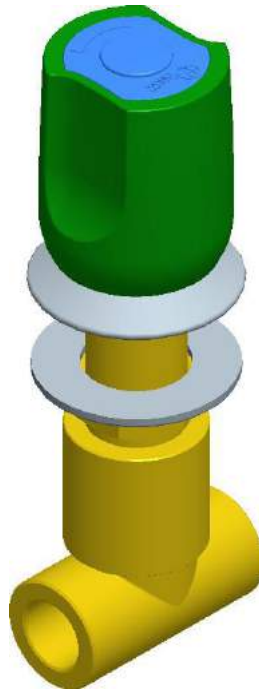

A01046
Comando
Remote control



A01047
Comando con biconi
Remote control with connections



AO1048

Comando per cappa montaggio frontale
Fume cupboard remote control frontal mounting



AO1049

Comando per cappa con flessibili montaggio frontale
Fume cupboard remote control with flex frontal mounting

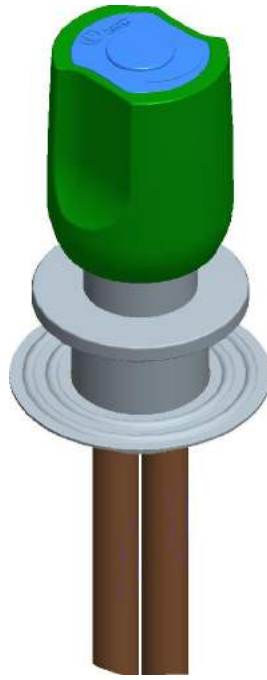

AO1050
Comando
Remote control

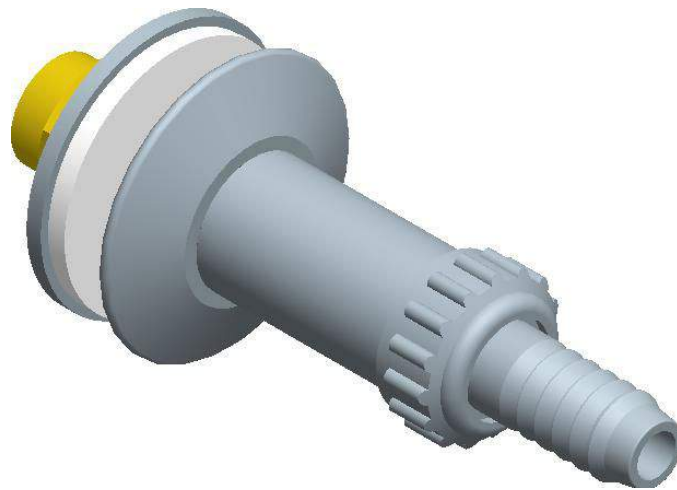

AO1051
Beccuccio dritto
Straight connection nozzle



A01052

Beccuccio a 90°
90° connection nozzle



A01053

Collo di cigno fisso per cappa
Fixed gooseneck spout for fume cupboard

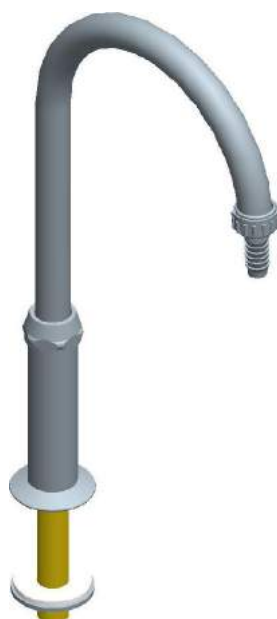

A01054

Collo di cigno girevole per cappa
Swivelling gooseneck spout for fume cupboard



A01055

Beccuccio a 45°
45° connection nozzle



AO1056

Beccuccio a 45° da banco
Bench-mounted 45° connection nozzle

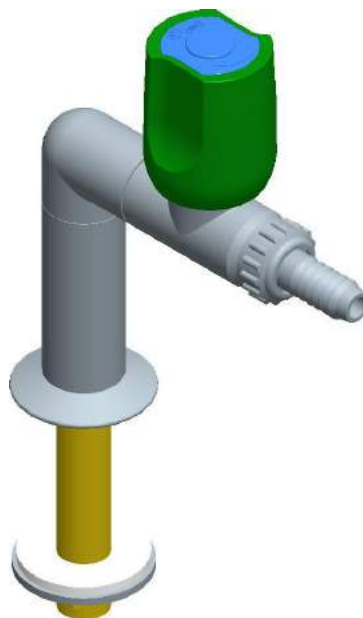

AO1060

Colonna a L
L standout

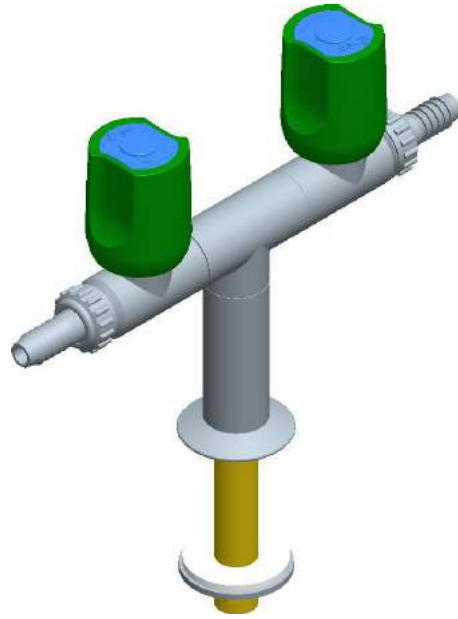

AO1061

Colonna a T
T standout



AO1062

Colonna a L a 1 rubinetto
L column with single tap



A01063

Colonna a T a 2 rubinetti
T column with 2 taps

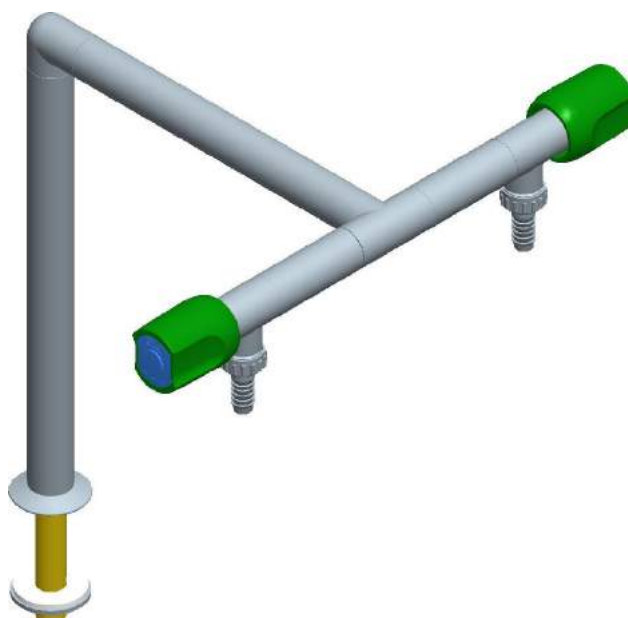

A01064

Colonna a T a 2 rubinetti
T column with 2 taps

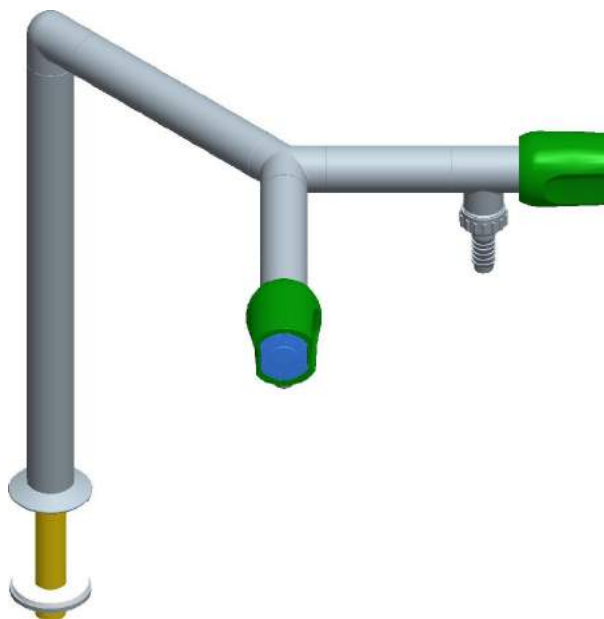

A01065

Colonna a V a 2 rubinetti
V column with 2 taps

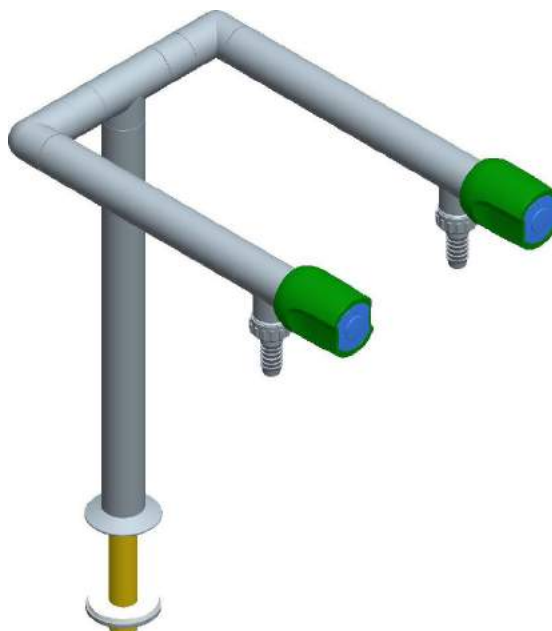

A01066

Colonna a U a 2 rubinetti
U column with 2 taps

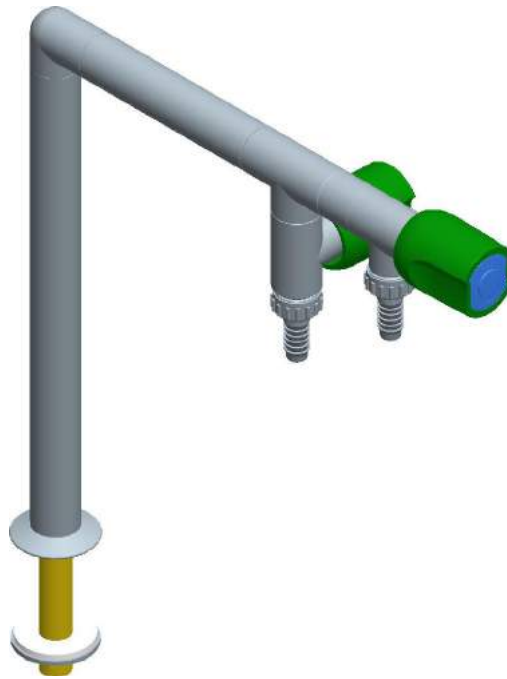

A01067

Colonna per pompa a vuoto con rubinetto destro e sinistro
Column for vacuum pump with right and left taps

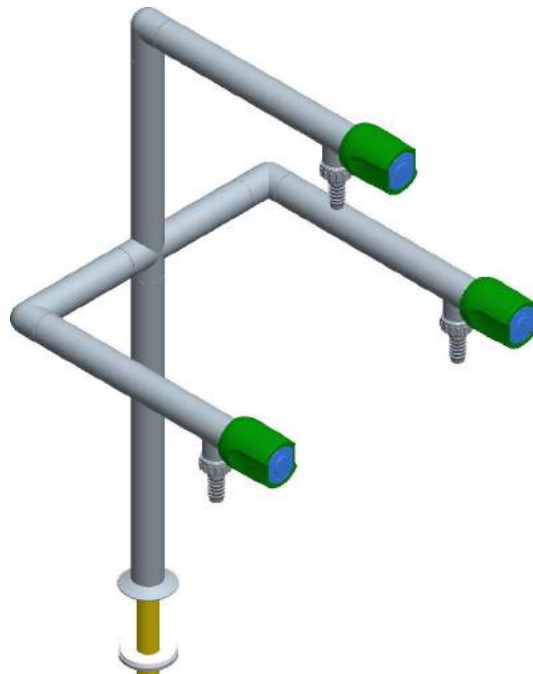

A01068

Colonna a 3 rubinetti
Column with 3 taps

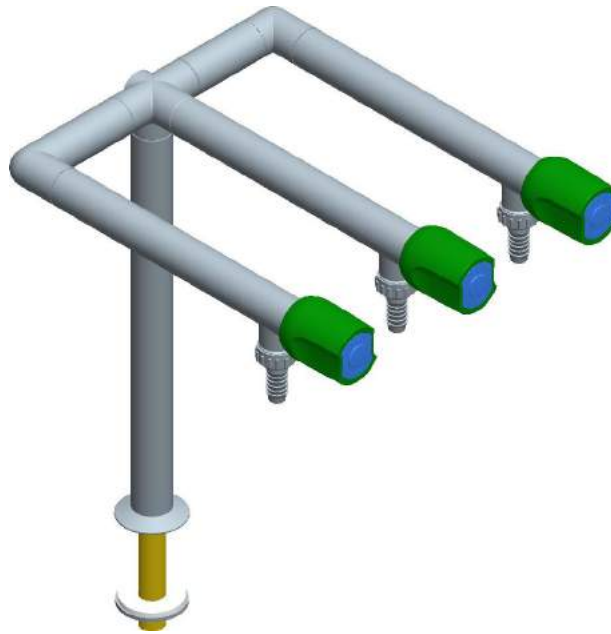

AO1069

Colonna a U a 3 rubinetti
U column with 3 taps

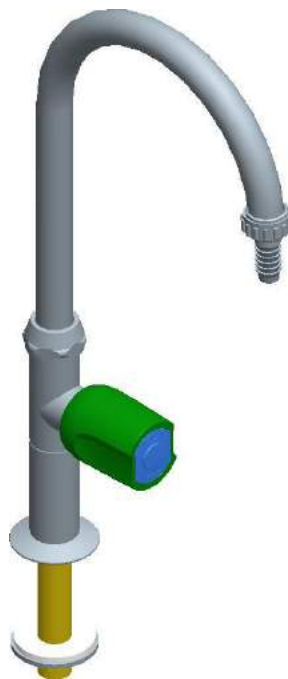

AO1070

Colonna collo cigno girevole con 1 rubinetto
Column with swivelling gooseneck spout and 1 tap

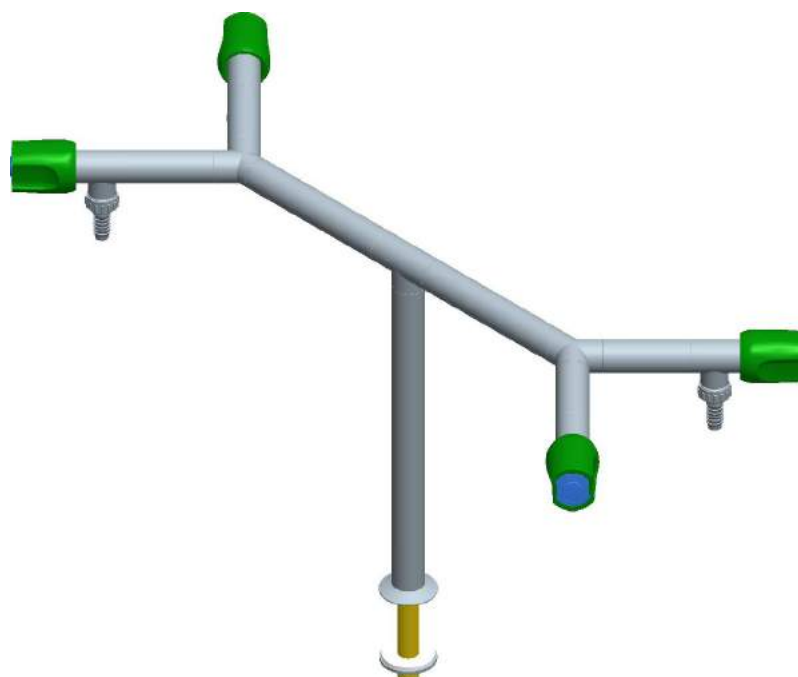

A01071

Colonna doppia a V con 4 rubinetti
Double V column with 4 taps

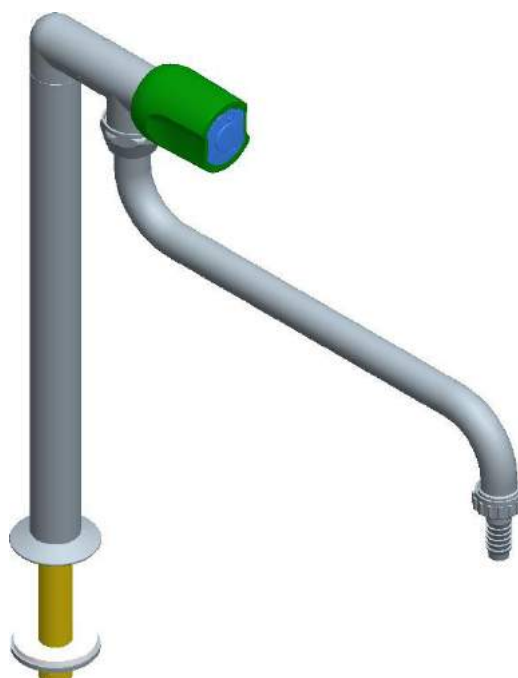

A01072

Colonna con canna a S girevole
Column with S swivelling spout



A01073

Colonna con canna girevole leva clinica e vitone ceramico
Column with swivelling spout and ceramic head valve



A01074

Colonna con rubinetto a leva clinica e vitone ceramico
Column with tap long lever and ceramic head valve

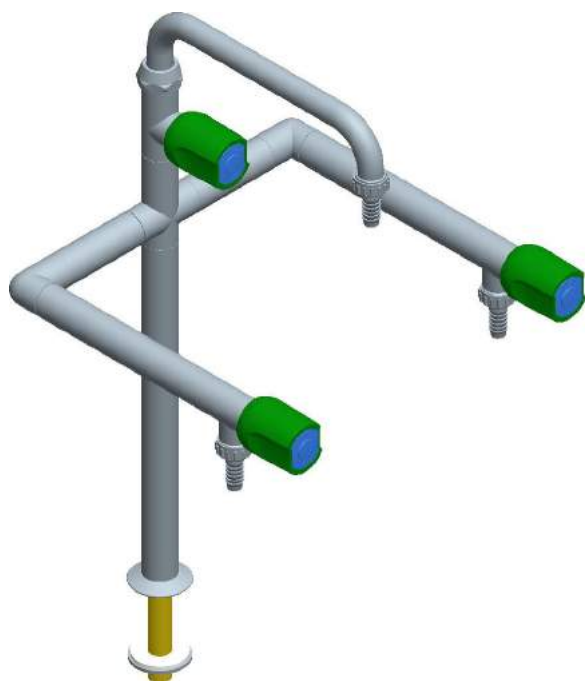

A01075

Colonna a U con 3 rubinetti e canna girevole
U column with 3 taps and swivelling spout

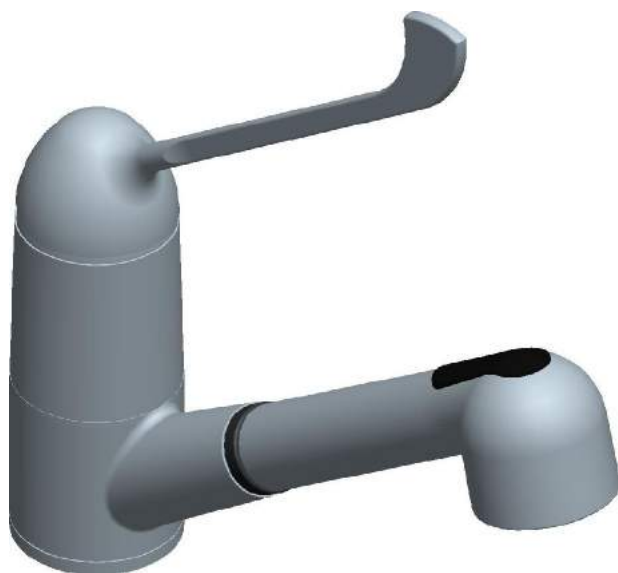

A01076

Miscelatore con doccia estraibile
Mixer with pull-out shower



AO1077

Monoforo con leve e vitoni ceramici
One hole mixer with levers and ceramic head valves



AO1078

Colonna collo di cigno a parete
Wall-mounted gooseneck column

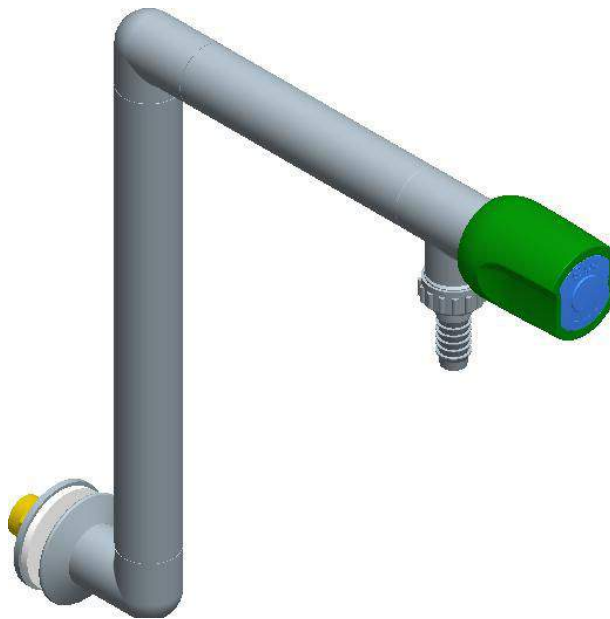

AO1079

Colonna a L a parete
Wall-mounted L column



AO1080

Miscelatore monoforo con canna a ponte
One hole mixer with angle spout



AO1081

Miscelatore monoforo
One hole mixer

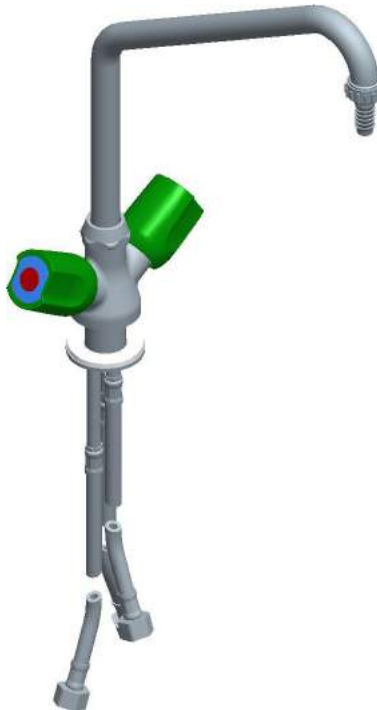

AO1081BP

Miscelatore monoforo bassa pressione
Low pressure one hole mixer

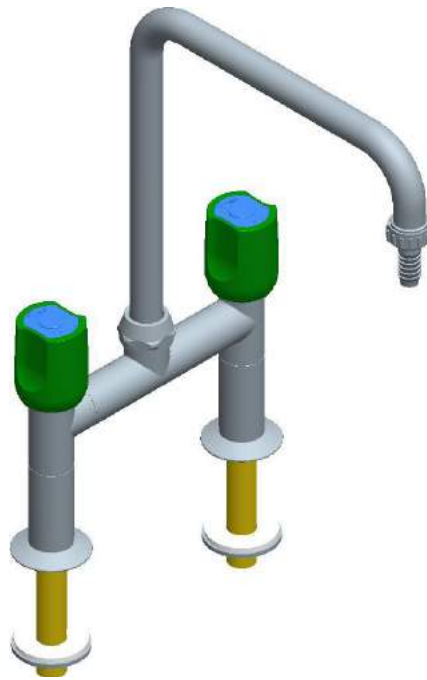

AO1082

Miscelatore da banco
Bench-mounted mixer

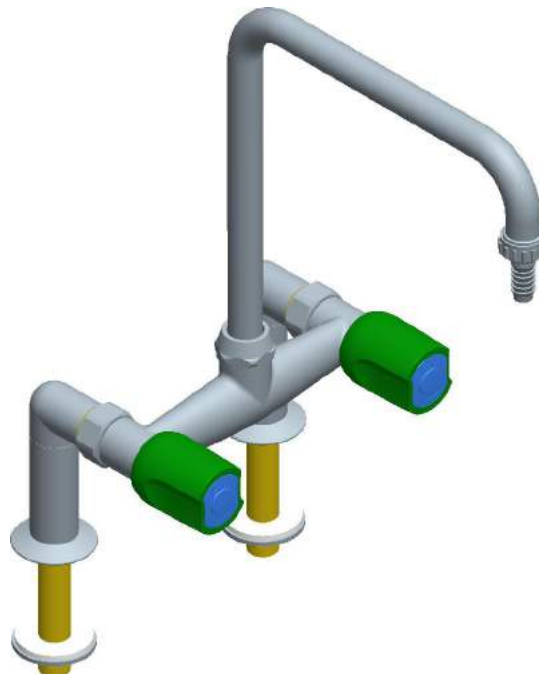

AO1083

Miscelatore da banco con maniglie frontali
Bench-mounted mixer with frontal handles



AO1084

Miscelatore da banco a leva clinica con areatore
Bench-mounted mixer with lever and aerator



AO1085

Miscelatore a leva clinica con piantana
Mixer with lever and stand

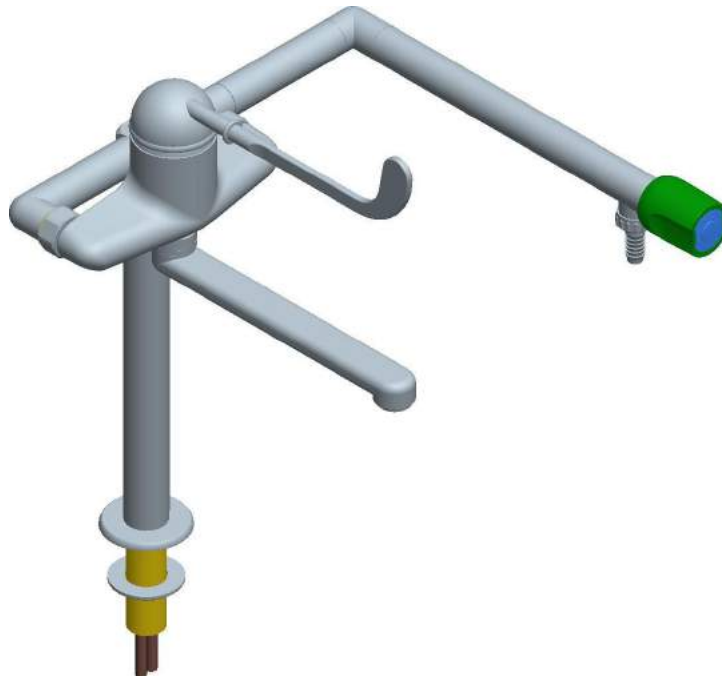

AO1086

Colonna a L a un rubinetto con miscelatore a leva clinica
L column with 1 tap and mixer with lever

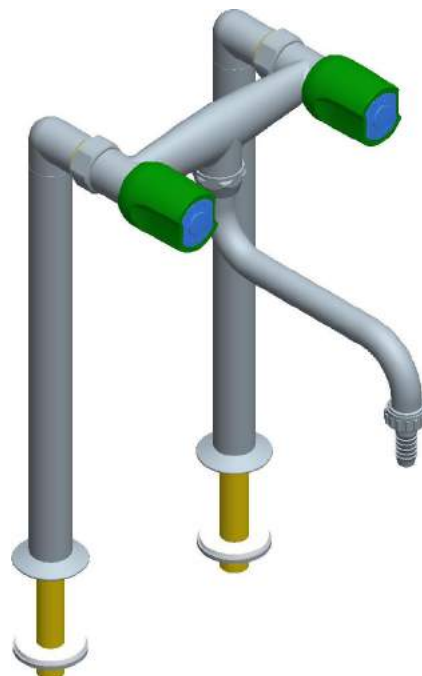

AO1087

Miscelatore con piantane e canna a S girevole
Mixer with S swivelling spout and stands

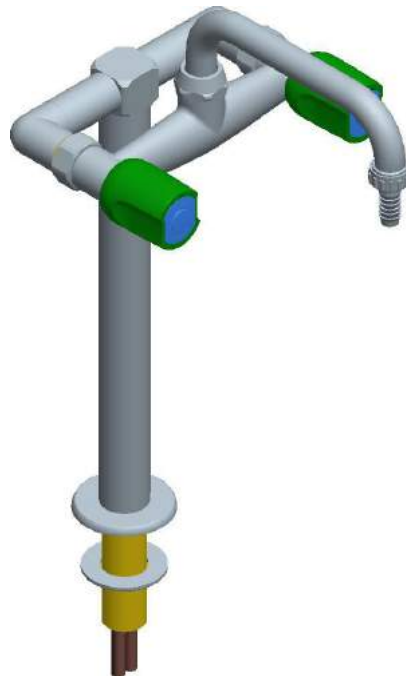

A01088

Miscelatore con piantana e canna a U girevole
Mixer with U swivelling spout and stand

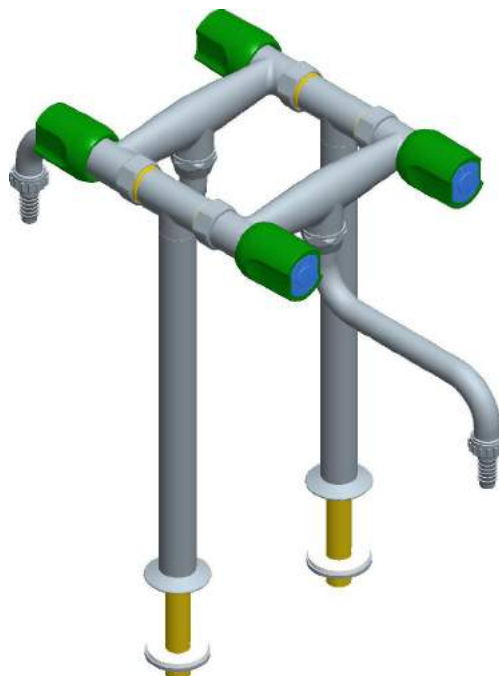

A01089

Miscelatore doppio con piantane e canne a S
Double mixer with S spouts and stands

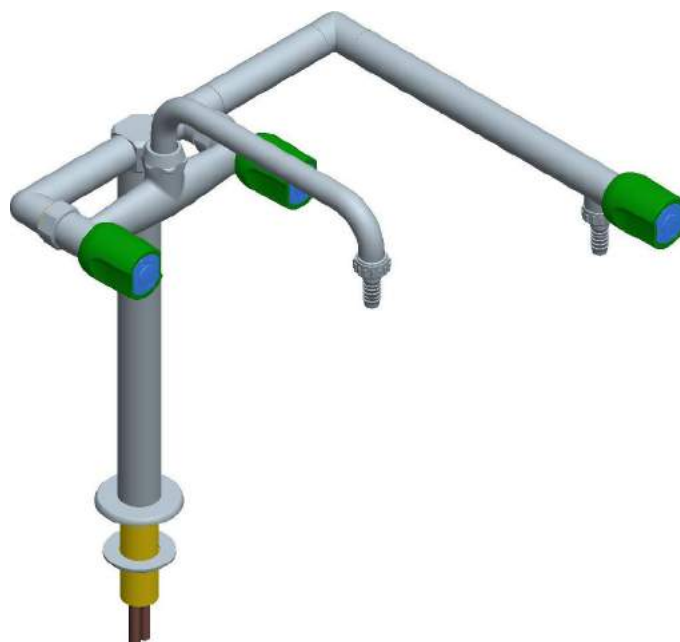

AO1090

Colonna a 1 rubinetto con miscelatore canna a U
1 tap column with U spout mixer



AO1091

Colonna a L a 1 rubinetto e 1 piano
1 tap L column and 1 level



AO1092

Colonna a T a 2 rubinetti e 1 piano
2 taps T column and 1 level

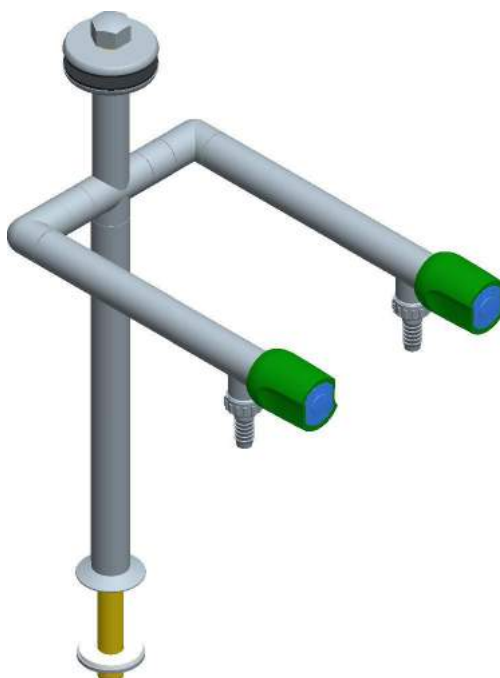

AO1093

Colonna a U a 2 rubinetti e 1 piano
2 taps U column and 1 level



AO1094

Colonna portacrystallo a 1 piano
Glass shelf column 1 level

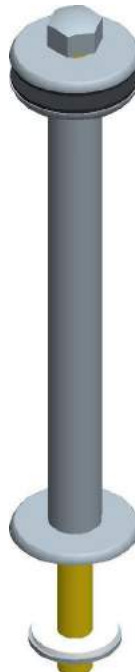

AO1095

Colonna portacrystallo secondo piano
Glass shelf column second level

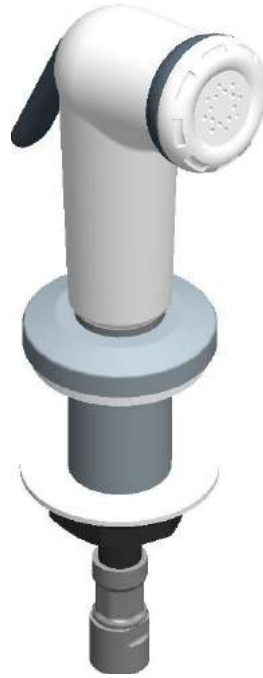

AO1096

Doccetta estraibile con flessibile mm. 1500
Pull-out shower with flex mm.1500

SPECIFICHE TECNICHE, RUBINETTI PER ACQUA

Utilizzo di barra ottone forata conforme alla norma EN 12168 e barra ottone piena conforme alla norma EN 12164, materiale stampato ricavato da barra piena EN 12165.

Portagomma smontabile, costruito secondo la norma DIN 12898.

Maniglie prodotte in polipropilene, materiale antiacido. Colorazione delle maniglie secondo la norma EN 13792.

Filettature secondo la norma ISO 228/1, classe di tolleranza B.

Rubinetteria costruita secondo la norma DIN 12918.

Pressione massima di utilizzo 7 bar.

Per l'acqua demineralizzata si effettua su tutti i rubinetti una nikelatura chimica interna con uno spessore minimo di 17 micron.

RUBINETTI ACQUA

Fornitura standard	Alternative senza modifica prezzo	Alternative con modifica prezzo
Portagomma svitabile	Portagomma fisso Indicare di seguito al nostro articolo F esempio: AO1000F ----- Aeratore 22x1 - per articoli provvisti in uscita di canna Indicare di seguito al nostro articolo A esempio: AO1081A	
Vitone a bagno d'olio e tenuta in EPDM		Vitone ceramico ¼ di giro Indicare di seguito al nostro articolo VC esempio: AO1003VC
Gamba 3/8" mm. 30 rubinetti a parete e mm. 80 rubinetti da banco	Gamba ½" mm. 30 rubinetti a parete e mm. 80 rubinetti da banco Indicare di seguito al nostro articolo 1/2" esempio: AO1062 ½"	
		A fronte di particolari esigenze, si possono inoltre apportate ulteriori modifiche per esempio di altezze, interassi ecc. Valutabili su specifica richiesta
Trattamento di nikelatura chimica per acqua demineralizzata: quotazione su richiesta		